

BRUCE HOUSE

(First Floor)



ADAM HOUSE

(Ground Floor)

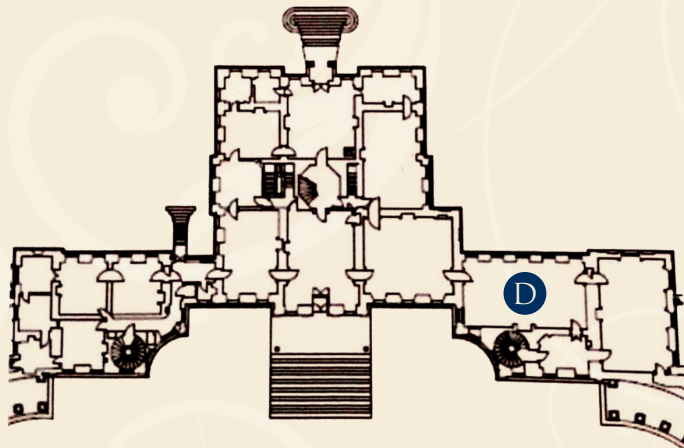

- A** Bedroom Mary taken to after attack (Season 2)
- B** Mary's bedroom in her uncle's house (Season 2)
- C** Hal Grey's Westminster Office (Season 7b)
- D** Duke of Sandringham's residence (Season 1)



HOPETOUN



OUTLANDER AT HOPETOUN HOUSE

Hopetoun has featured as many locations in seasons 1, 2, 3 & 7b of Outlander.

It has played a wide variety of places, including the Duke of Sandringham's residence, some of the Parisian scenes and several scenes from the Helwater and Elsmere estates.

The guides within Hopetoun can help with directions for the scenes shot within the house and this map also shows the external locations filmed out in the grounds.



- 1 Exterior of Elsmere (Season 3)
- 2 Exterior of Maison de Madame Elise (Season 2)
- 3 Paris market street (Season 2)
Scene of attack on Mary & Clare (Season 2)
Exterior of Helwater Stables (Season 3)
- 4 Fergus chased by Jamie (Season 2)
- 5 Duke of Sandringham's duel (Season 1)
Jamie's sword fight with MacDonald's (Season 1)
- 6 Jamie sees Willie in pram (Season 3)
- 7 Jamie drops Geneva in puddle (Season 3)
- 8 Jamie & Geneva riding horses (Season 3)
- 9 Jamie teaches Willie to ride a horse (Season 3)
- 10 Entrance to Duke of Sandringham's (Season 1)